

TIPOLOGIE DI SPALLE E TRAVERSI STANDARD E SPECIAL (LE BATTUTE ESTERNE E DI FISSAGGIO, POSSO ESSERE, A SCELTA, DA 30 A 50mm)

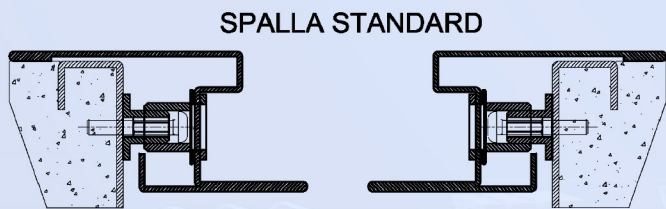

SPALLA STANDARD

A1

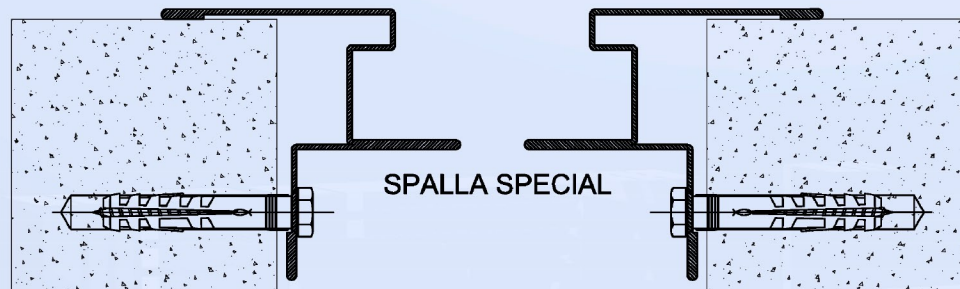

SPALLA SPECIAL

B1

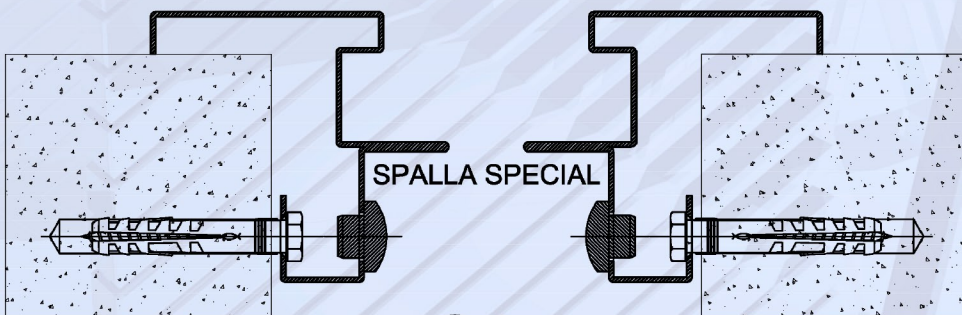

SPALLA SPECIAL

C1

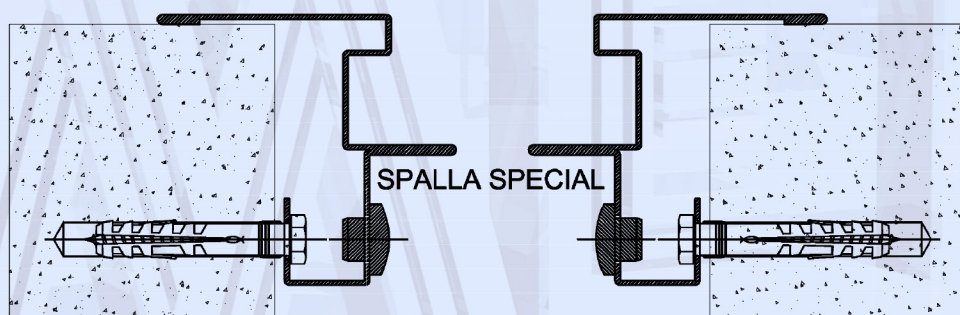

SPALLA SPECIAL

D1

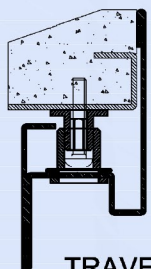

TRAVERSO SUP.
STANDARD

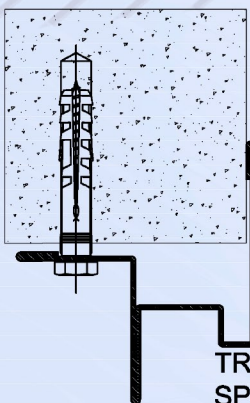

TRAVERSO SUP.
SPECIAL

B1

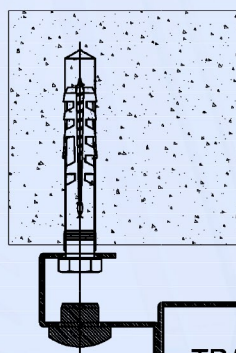

TRAVERSO SUP.
SPECIAL

C1

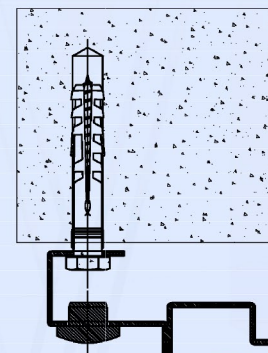

TRAVERSO SUP.
SPECIAL

D1

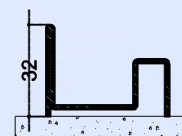

SOGLIA